



Carpet

Replacement

SRS wire harnesses are routed near the carpet.

CAUTION:

- All SRS wiring harnesses are covered with yellow outer insulation.
- Before disconnecting any part of the SRS wire harness, install the short connectors (see page 23-371).
- Replace the entire affected SRS harness assembly if it has an open circuit or damaged wiring.

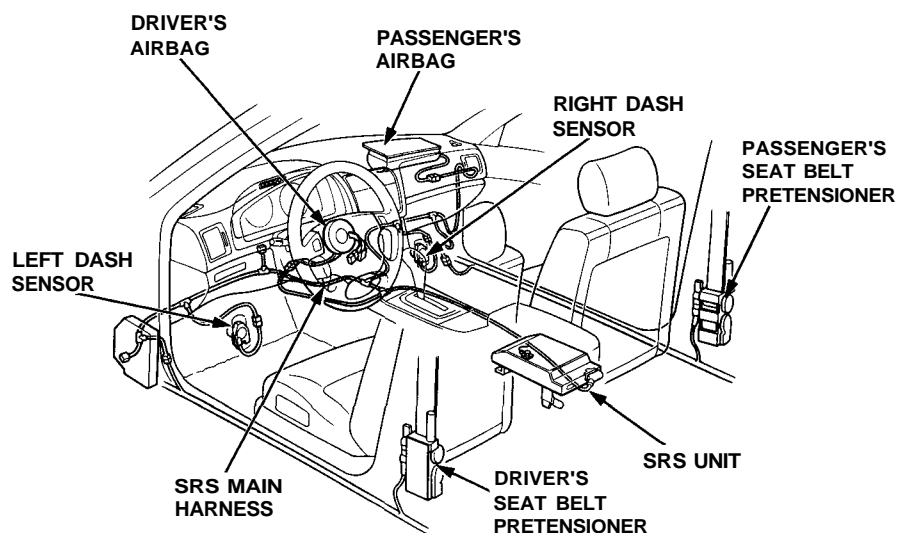

1. Remove:

- Front seats (see page 20-46)
- Rear seat cushion (see page 20-66)
- Center console panel (see page 20-75)
- Center armrest (see page 20-75)
- Stereo radio/cassette (see page 20-76)
- Glove box lower panel (see page 20-79)
- Glove box and glove box panel (see page 20-79)
- Dashboard lower cover (see page 20-77)
- Center console (see page 20-75)
- Opener cover (see page 20-89)
- Quarter trim panel (see page 20-16)
- Door sill moldings and door trims (see page 20-43)
- Footrest and pedal stopper
- Carpet lid

NOTE: The original radio has a coded theft protection circuit. Be sure to get the customer's code number before – disconnecting the battery.

– removing the No. 56 (7.5 A) fuse from the under-hood fuse/relay box.

– removing the radio.

After service, reconnect power to the radio and turn it on. When the word "CODE" is displayed, enter the customer's 5-digit code to restore radio operation.

2. Pry out the clips at the rear edge and bottom of the center armrest.
3. Cut the (A) area first, then pull back the carpet as shown (see page 20-74).
4. Remove the carpet by sliding it rearward.

(cont'd)

Carpet

Replacement(cont'd)

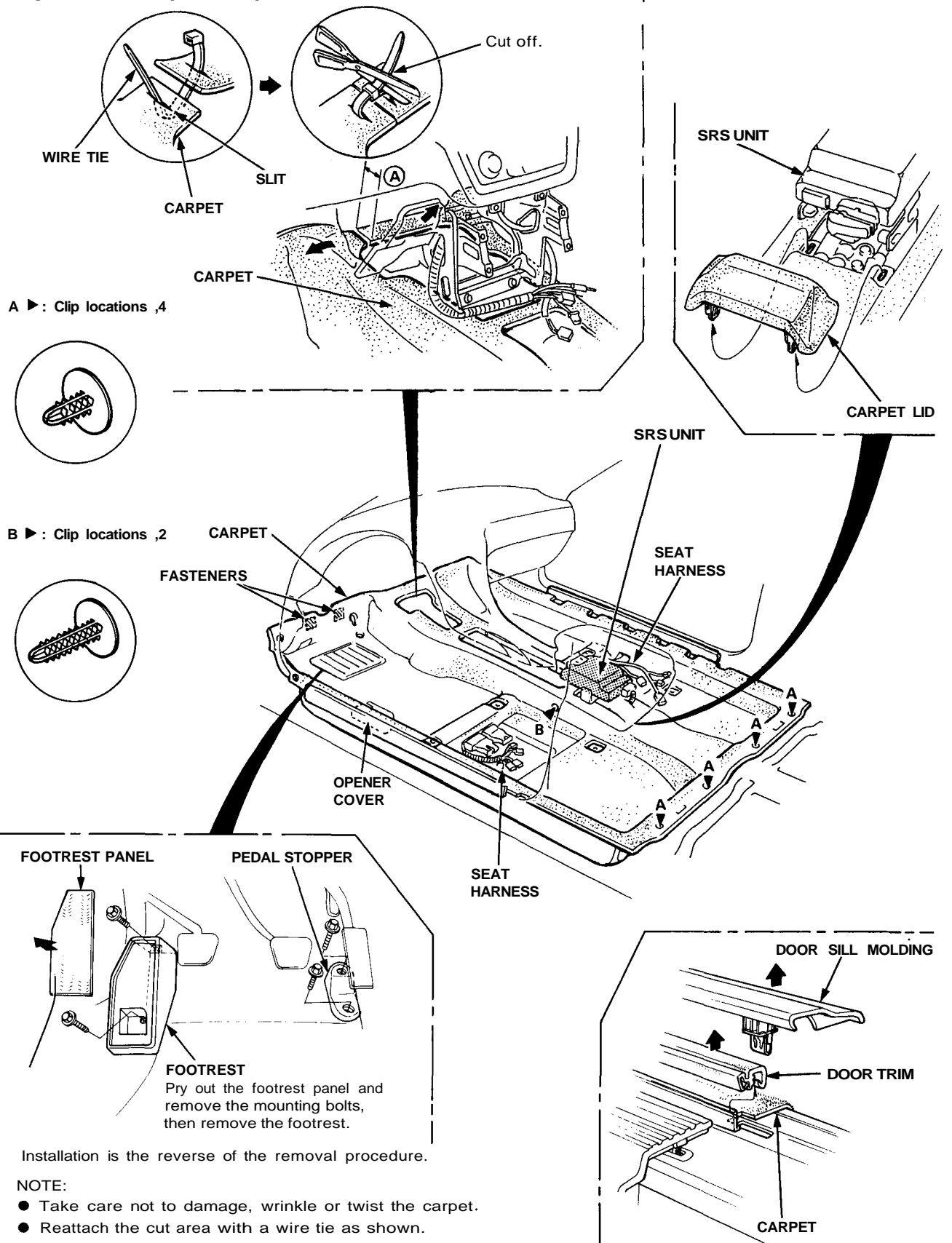

5. Installation is the reverse of the removal procedure.

NOTE:

- Take care not to damage, wrinkle or twist the carpet.
- Reattach the cut area with a wire tie as shown.
- Make sure the seat harnesses are routed correctly.